

FIT INSTRUCTIONS**CHEST PLATE™ HARNESS**

1. LOOSEN STRAPS & UNCLIP BOTH BUCKLE
2. WITH HARNESS ON THE GROUND, STEP DOG'S RIGHT LEG INTO POSITION
NOTE: THE WIDER PART OF THE CHEST PLATE GOES NEAR THE DOG'S HEAD
3. STARTING WITH THE NECK STRAP, CLIP STRAPS TOGETHER
4. ADJUST STRAPS TO FIT YOUR DOG

TIP: KEEP THE NECK STRAP A LITTLE LOOSE SO THAT THE GIRTH STRAP DOES NOT PULL INTO YOUR DOG'S LEGS

IMPORTANT: DO NOT OVER-TIGHTEN STRAPS! WHEN FITTED CORRECTLY, HARNESS SHOULD BE SNUG, BUT TWO FINGERS SHOULD EASILY RUN BETWEEN STRAPS & DOG.

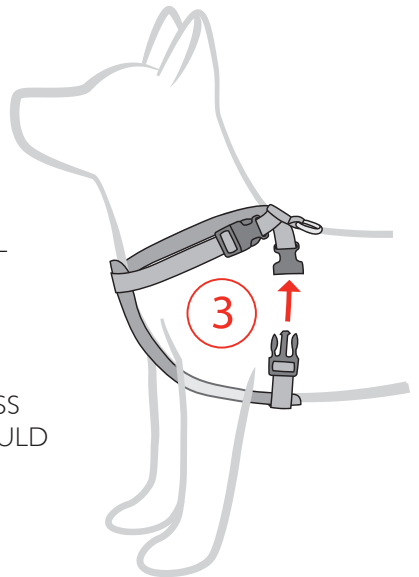
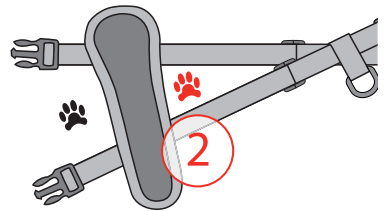

NOW GO AND PLAY!

for more information go to
www.ezydog.com